

SECTION S1 1:100

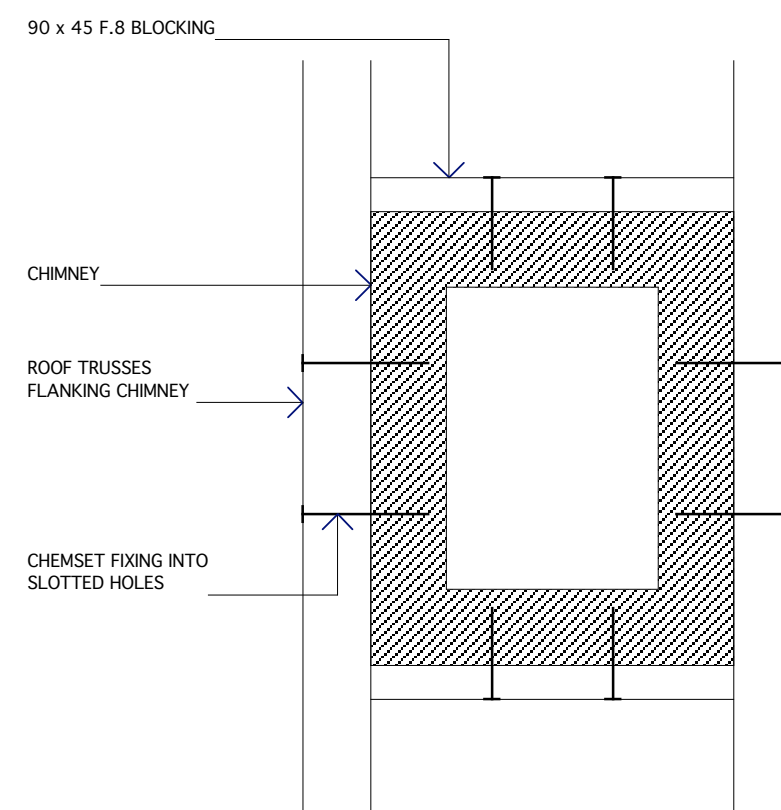

ENGINEERS DETAIL 1:10
TRUSS SYSTEM CONNECTING TO CHIMNEYS

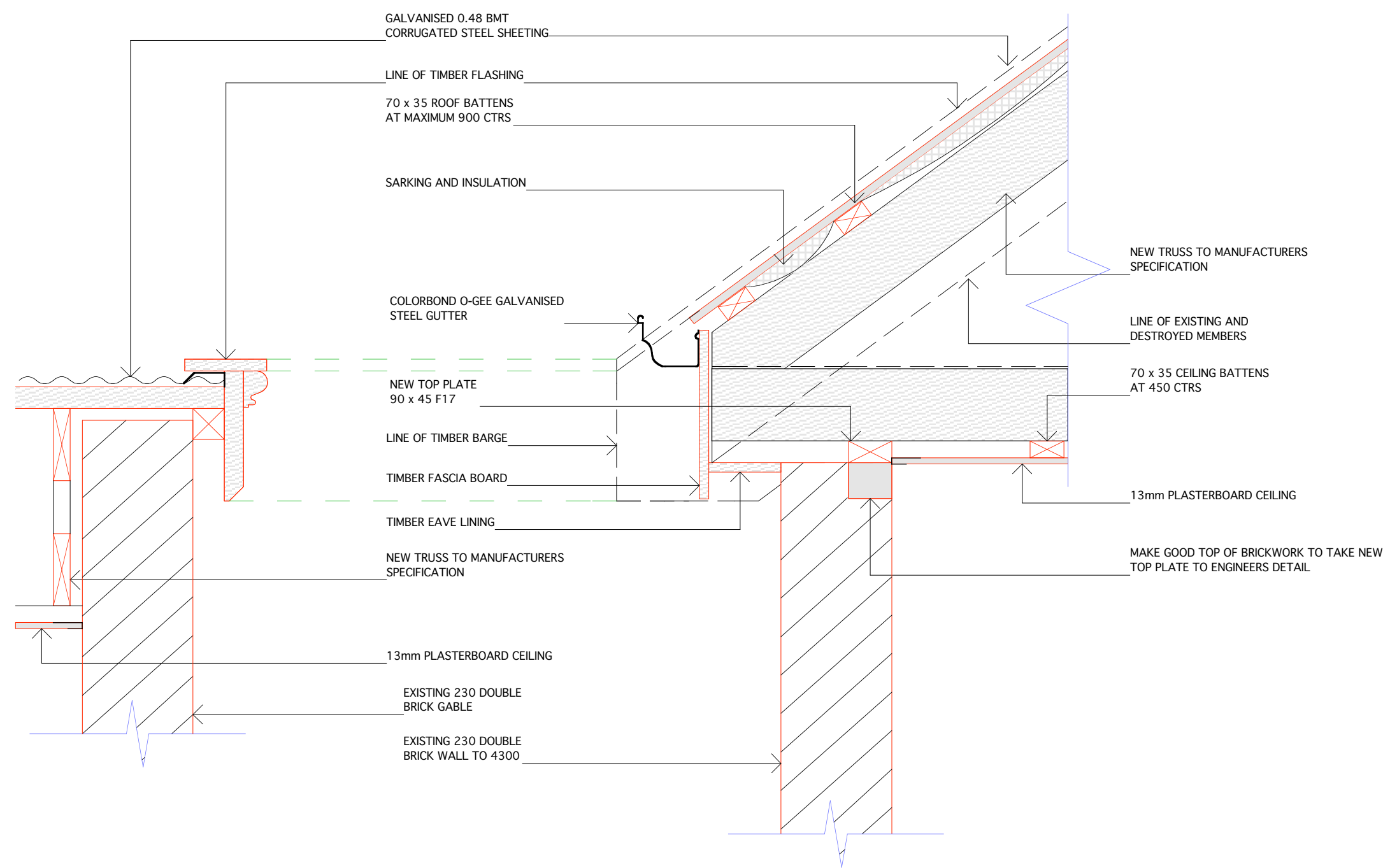

BARGE DETAIL 1:10

DETAIL D.01, 1:10

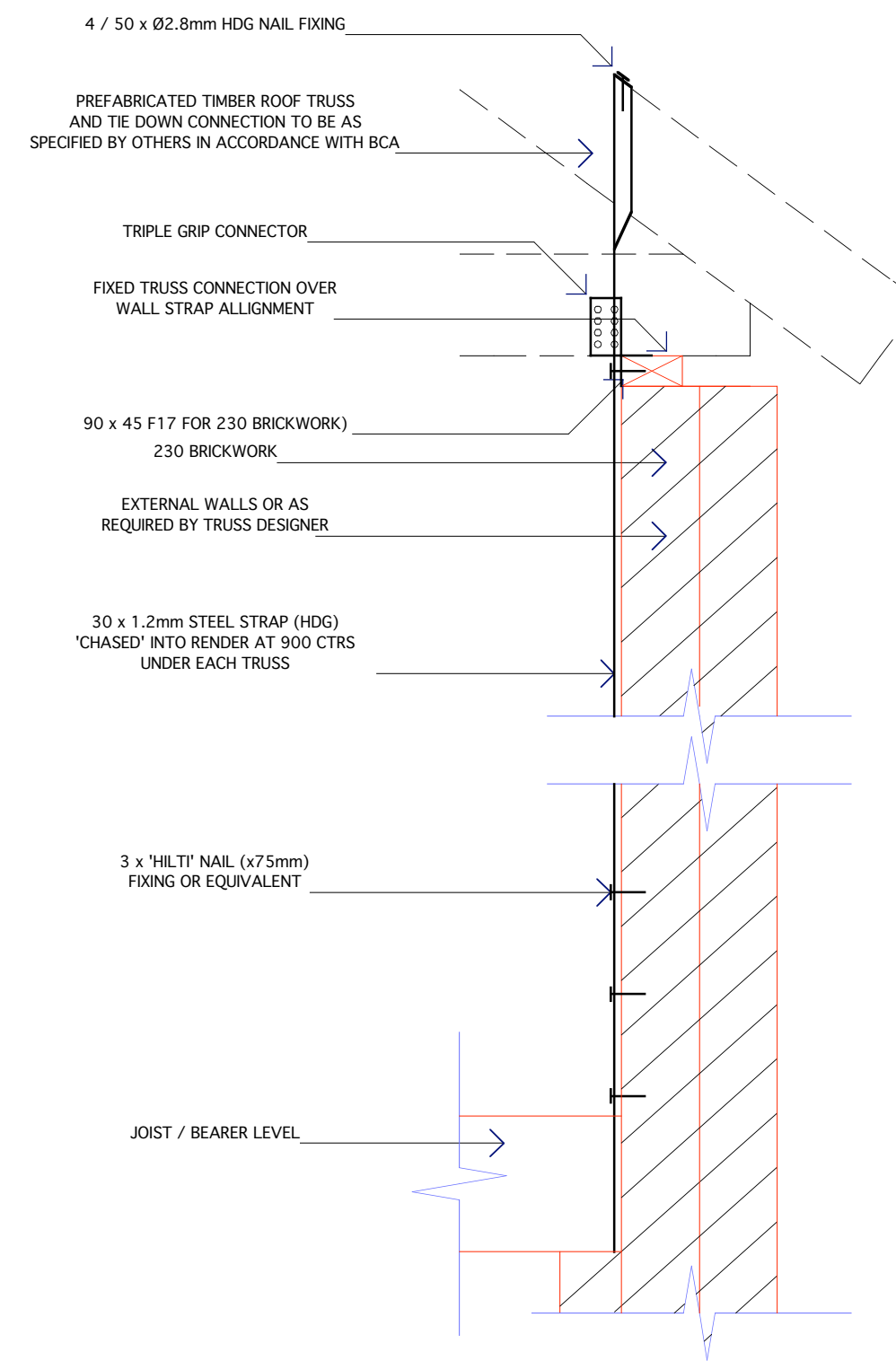

ENGINEERS DETAIL 1:10

SCOPE OF WORKS

1. INCLUDE PRELIMINARIES, TEMPORARY SCAFFOLDING, LABOUR, SUPERVISION, SIGNAGE, FENCING, AMENITIES, SITE STORAGE AND SERVICES
2. REPAIR AND REPLACE DAMAGED AND MISSING BRICKWORK TO TOP COURSE OF BRICK WALLS
3. CHIMNEY NUMBER 8 TO BE REBUILT TO MATCH EXISTING CHIMNEYS
4. PROVIDE TIMBER TOP PLATES AND TIE DOWNS TO BRICK WALLS. REINSTATE ANY TIMBER LINTELS OVER OPENINGS TO SUPPORT ROOF TRUSSES
5. DESIGN, FABRICATE AND INSTALL PREFABRICATED ROOF TRUSSES TO MANUFACTURERS SPECIFICATION. TRUSSES TO BE AT MAX 900 CENTRES AND DESIGN IN ACCORDANCE WITH THE AUSTRALIAN BUILDING CODE
6. INSTALL TRUSSES IN A MANNER WHICH GIVES SUPPORT TO THE EXISTING CHIMNEY STACKS. PROVIDE ALL NECESSARY INCIDENTAL SUPPORTS FOR RIDGES, VALLEYS AND BOX GUTTERS
7. TRUSS MANUFACTURER TO PROVIDE AND BE RESPONSIBLE FOR SHOP DRAWINGS. SHOP DRAWINGS ARE TO BE APPROVED BY THE STRUCTURAL ENGINEER PRIOR TO MANUFACTURE.
8. PROVIDE TIMBER ROOF BATTENS AT MAX 900 CENTRES INCLUDING INSULATION BLANKET AND ALUMINIUM SARKING SHEET
9. PROVIDE 0.48 BMT CORRUGATED GALVANISED STEEL ROOF SHEETING. PROVIDE ALL NECESSARY FIXINGS AND GALVANISED STEEL VALLEY FLASHINGS, BOX GUTTERS, RIDGE AND HIP CAPPINGS
10. REINSTALL AND WHERE NECESSARY PROVIDE NEW LEAD FLASHING TO CHIMNEY STACKS
11. RECONSTRUCT ALL TIMBER FASCIAS, BARGES, EAVES LINING AND INCIDENTAL TRIMS TO AFFECTED, DAMAGED OR OMITTED BARGES, EAVES OR FASCIAS. TIMBER SPECIES TO BE SIMILAR TO EXISTING TYPE (HARDWOOD) SEASONED AND PRIMED IN PROFILES TO MATCH EXISTING
12. INSTALL WHERE NECESSARY ANY INCIDENTAL BARGE AND SOAKER FLASHINGS
13. PROVIDE COLORBOND STEEL GUTTER SIMILAR IN PROFILE AND COLOR TO EXISTING COMPLETE WITH REINSTATEMENT OF GALVANISED STEEL CIRCULAR DOWNPIPES AND BRACKET SUPPORTS / FIXINGS. CONNECT DOWNPIPES UP TO EXISTING STORMWATER SYSTEM WHERE PREVIOUSLY CONNECTED
14. PROVIDE A COMPLETE 13MM PLASTERBOARD CEILING WITH BATTEN SUPPORTS, TAPE JOINTS AND SQUARE SET CORNICE. CEILING LINING TO BE SANDED, UNDERCOATED AND PAINTED. ALLOW FOR DECORATIVE CEILING PANELS SIMILAR TO EXISTING ADJACENT CEILING PANELS WHERE NECESSARY
15. ALL RECONSTRUCTED TIMBER FASCIAS, BARGES, EAVES LINING AND INCIDENTAL TRIMS TO BE PAINTED OF SIMILAR COLOUR TO MATCH EXISTING
16. REMOVE ALL BUILDER RUBBISH AND DEBRIS AT COMPLETION OF THE WORK

Rev.	Date	Description	Appr.	Rev.	Date	Description	Appr.
-	21.11.05	DRAFT	MMA				
A	8.12.05	PRELIMINARY SKETCH DESIGN	MMA				
B	31.01.06	REV. PRELIMINARY SKETCH DESIGN	MMA				
C	3.03.06	PRELIM. DA ISSUE	MMA				
D	17.08.06	DEVELOPMENT APPLICATION ISSUE	MMA				

NOTES

- * ALL WORK SHALL COMPLY WITH THE BCA, ALL RELEVANT SAA CODES AND AUTHORITY REGULATIONS
- * ALL DIMENSIONS SHALL BE CHECKED ON SITE BEFORE WORK BEGINS
- * FIGURED DIMENSIONS TAKE PRECEDENCE OVER SCALED
- * COPYRIGHT OF THIS DRAWING AND ANY WORKS EXECUTED FROM IT SHALL REMAIN THE PROPERTY OF MICHAEL MARSHMAN & ASSOCIATES PTY LTD ©

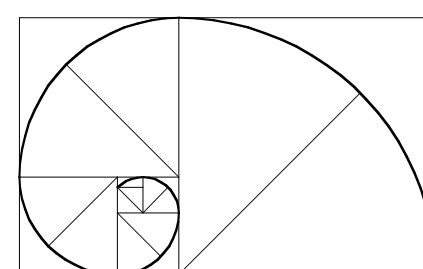

MICHAEL MARSHMAN & ASSOCIATES PTY LTD ARCHITECTS

CHARTERED ARCHITECT:
MICHAEL MARSHMAN B Sc(Arch) B Arch RAlA

1 KEMP BUILDING AYRES WALKWAY BEGA
PO BOX 323 BEGA NSW 2550
PH (02) 6492 5400 FAX (02) 6492 3455
Email: mmabega@yahoo.com.au

Project
OLD BEGA HOSPITAL

Description
SECTION & DETAILS

Issued: 21 NOVEMBER 2005	Drawn: DG
Project No. 0517	Scale 1:100 1:10
Drawing No. A.03 (d)	